

## 1406 Connect Adaptor

### Senko ADAPTOR

#### ADP1700

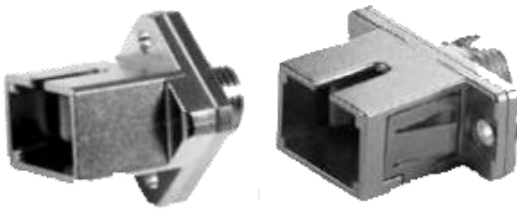

FC to SC Fiber Optic Adaptor

#### ADP1800



Senko FC (Oval Flange)

#### ADP1801



Senko FC (Square Flange)

#### FEATURES

- FC Square, High Density Rectangular, Square, Oval and Duplex Type Available
- UPC Type Adaptor have Wide Key of 2.15 mm
- APC Type Adaptor have Narrow Key of 2.05 mm
- Typical Insertion Loss under 0.05 dB and Max IL of 0.20 dB
- High Quality and Durable Ni-Plated Brass Body

**Order notes to our customers:** The default parameters are as follows. For special needs, please contact sales.

**1) Connector FC/APC, 900 um, 1 m by default for all devices except for high power devices.**

**2) Slow axis working, fast axis blocked, connector key is aligned to slow axis by default for PM devices.**

# 1406 Connect Adaptor

## Senko ADAPTOR

### ADP1802

Senko SCA (Green)



### ADP1803

Senko SCU (Blue)



#### FEATURES

- Highest Quality Adaptor Series
- Patented One Piece Housing Design Prevents Housing Breakage
- Designed to Exceed the Requirement of the Verizon FOC TPR 9409 Requirement
- High TG Hook Prevents Unwanted Hook Opening in OSP Application
- Typical Insertion Loss under 0.05 dB and max. IL of 0.20 dB
- Shutter Option Ready for Eye Safety

### ADP1804

Senko LCA (Green)



### ADP1805

Senko LCU (Blue)



#### FEATURES

- Compact Design
- RJ-45 Style Interface
- Simplex and Duplex Type Available
- Telcordia, ANSI, TIA/EIA, and IEC Compliance\*
- Color Coding
- High Precision Alignment with Zirconia Sleeve or Metal Sleeve

**Order notes to our customers:** The default parameters are as follows. For special needs, please contact sales.

**1) Connector FC/APC, 900 um, 1 m by default for all devices except for high power devices.**

**2) Slow axis working, fast axis blocked, connector key is aligned to slow axis by default for PM devices.**